

TI 1095 – Displaced drain solenoid tube

On Generation 6 washers equipped with water-operated drain valves, it is possible for the plastic tubing between the “R” port of the drain solenoid pilot valve and the siphon breaker (item 4 in the accompanying illustration) to come out of its siphon breaker fitting. This may expose components inside the machine to water, causing malfunctions.

At the next service opportunity, remove this tube from the siphon breaker fitting, coat the outside of the tube with silicone sealant / adhesive, and firmly push the tube back into the siphon breaker fitting. Test the drain valve operation to insure that the tube is not obstructed by the silicone sealant / adhesive.

Call Wascomat Technical Support at 516-371-0700 for assistance.

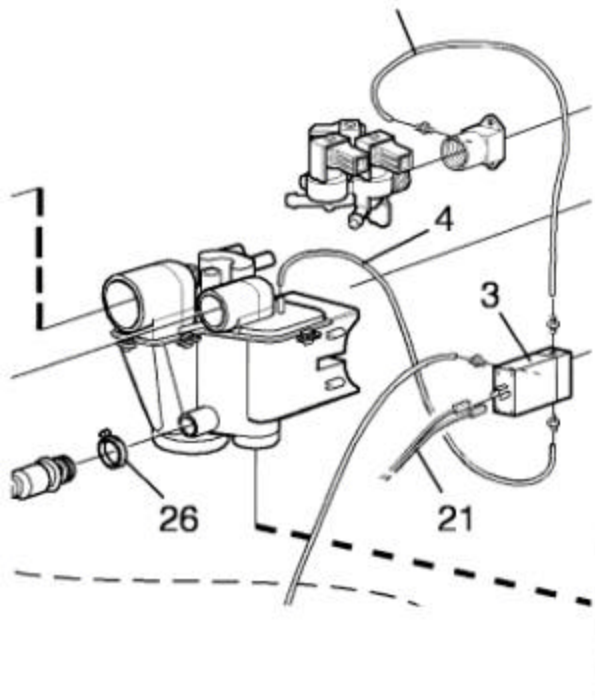

4/01/03